

REVISIONS						
ZONE	LTR.	DESCRIPTION	ECN NO.	DATE	BY	APPR'D
	A	RELEASED FOR PRODUCTION	DR7833	4/4/06	DPZ	
3B	B	B1 ADDED SLEEVE	CR71236	9/7/07	DJC	
2B 1A	C	C1 TIE WRAP WAS SLEEVE C2 UPDATED NOTES	71450	27MAY08	SLK	DJC
3B		D1 UPDATE ASSEMBLY TO PUMP CAP/DOME COVER PLATE DESIGN	DR23287			
4C	D	D2 ADD WIRE HARNESS DETAIL D3 RV0000316 WAS RV0000318 D4 TU212 WAS FM0001785 ON CHART DRAWING SA0039243	71853 72049	30APR09	WDE	DJC
3A	E	E1 REPLACED "HOT STAMP INFO" WITH "MARKING INFO"	73288	02DEC10	SLK	DJC

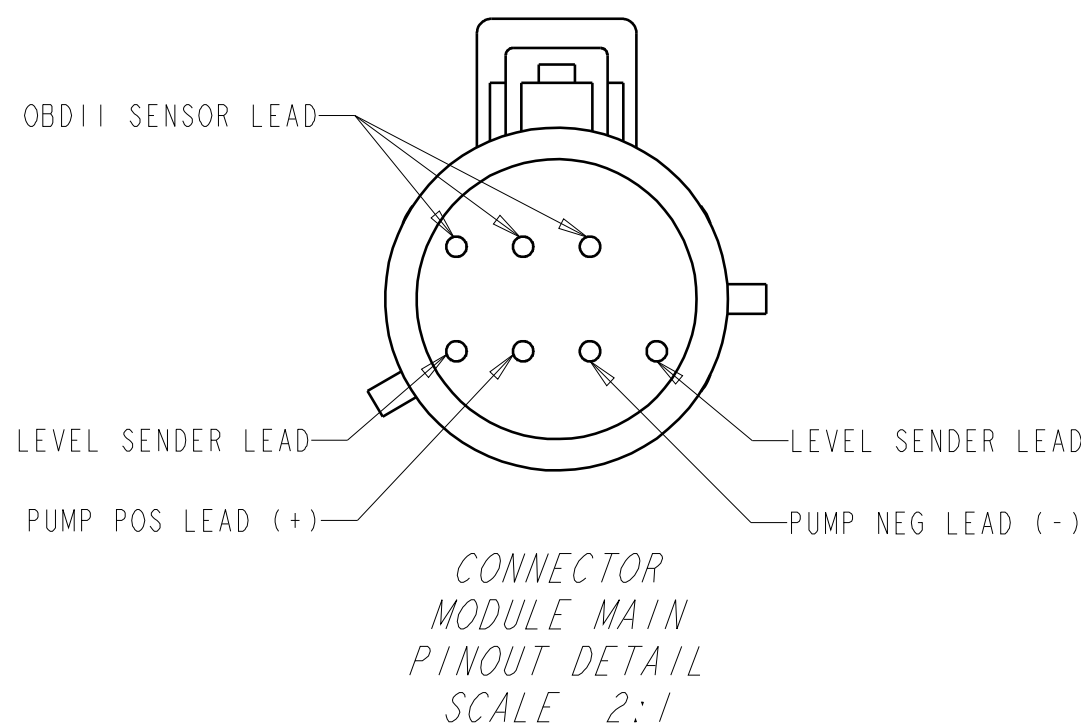

WIRE HARNESS DETAIL

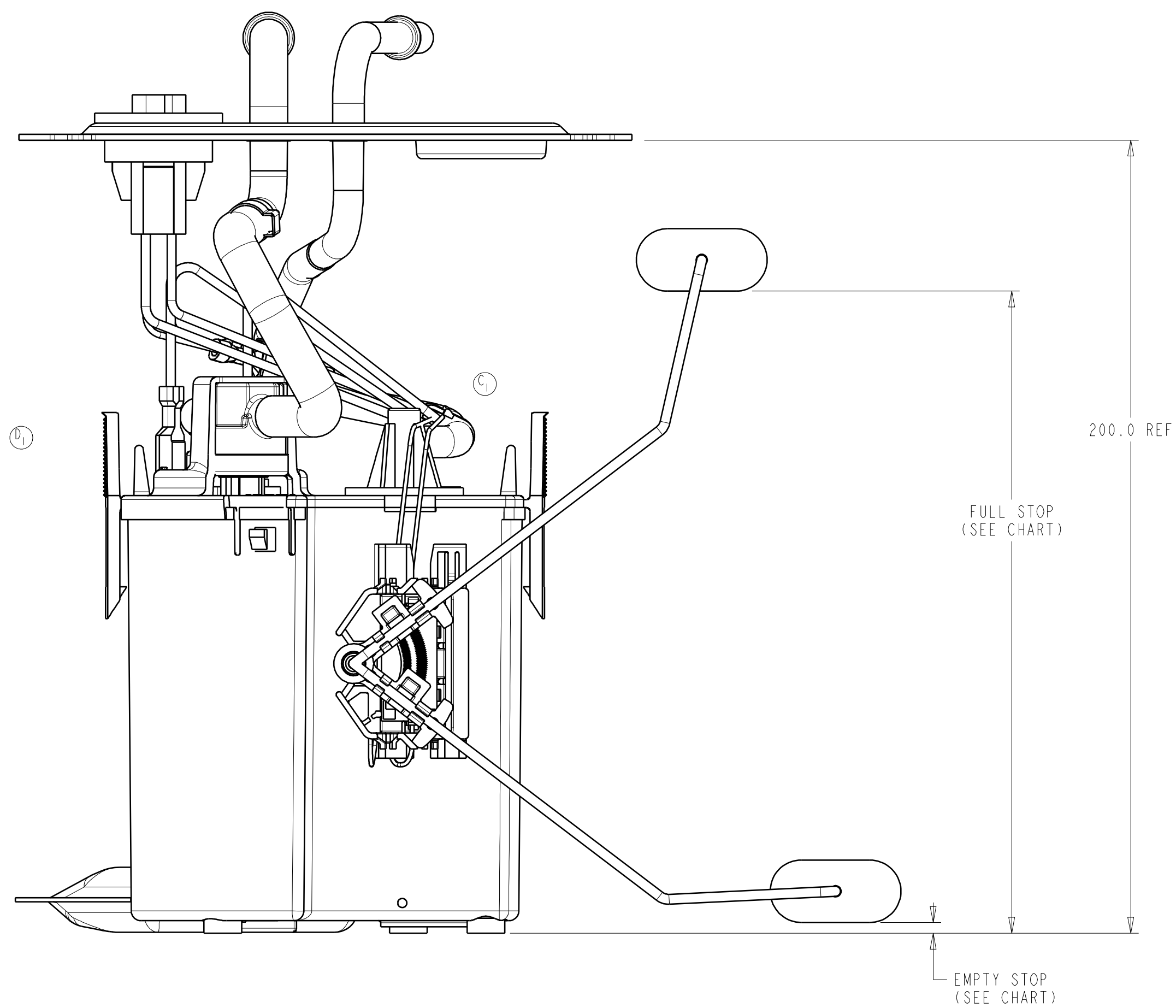
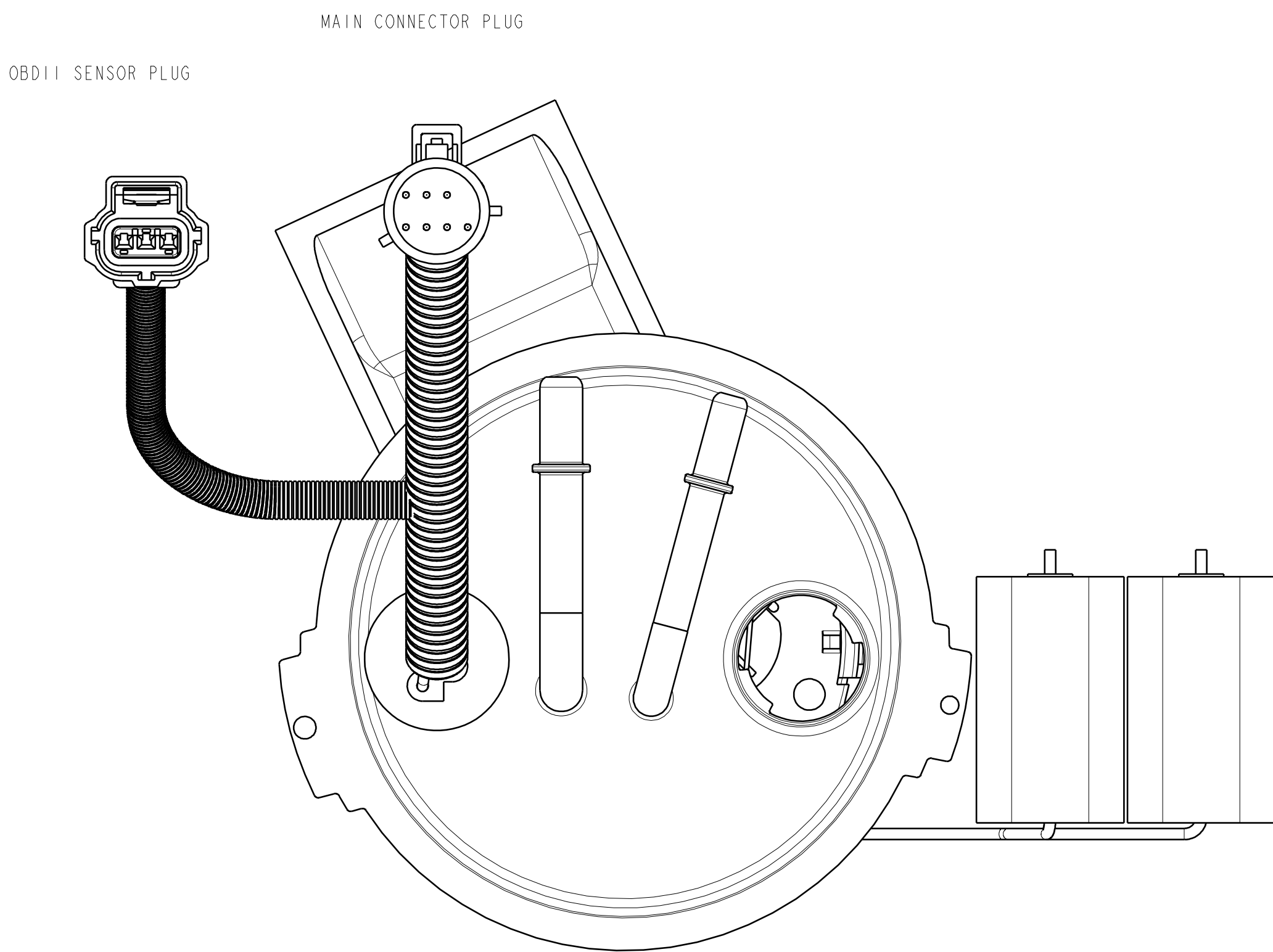
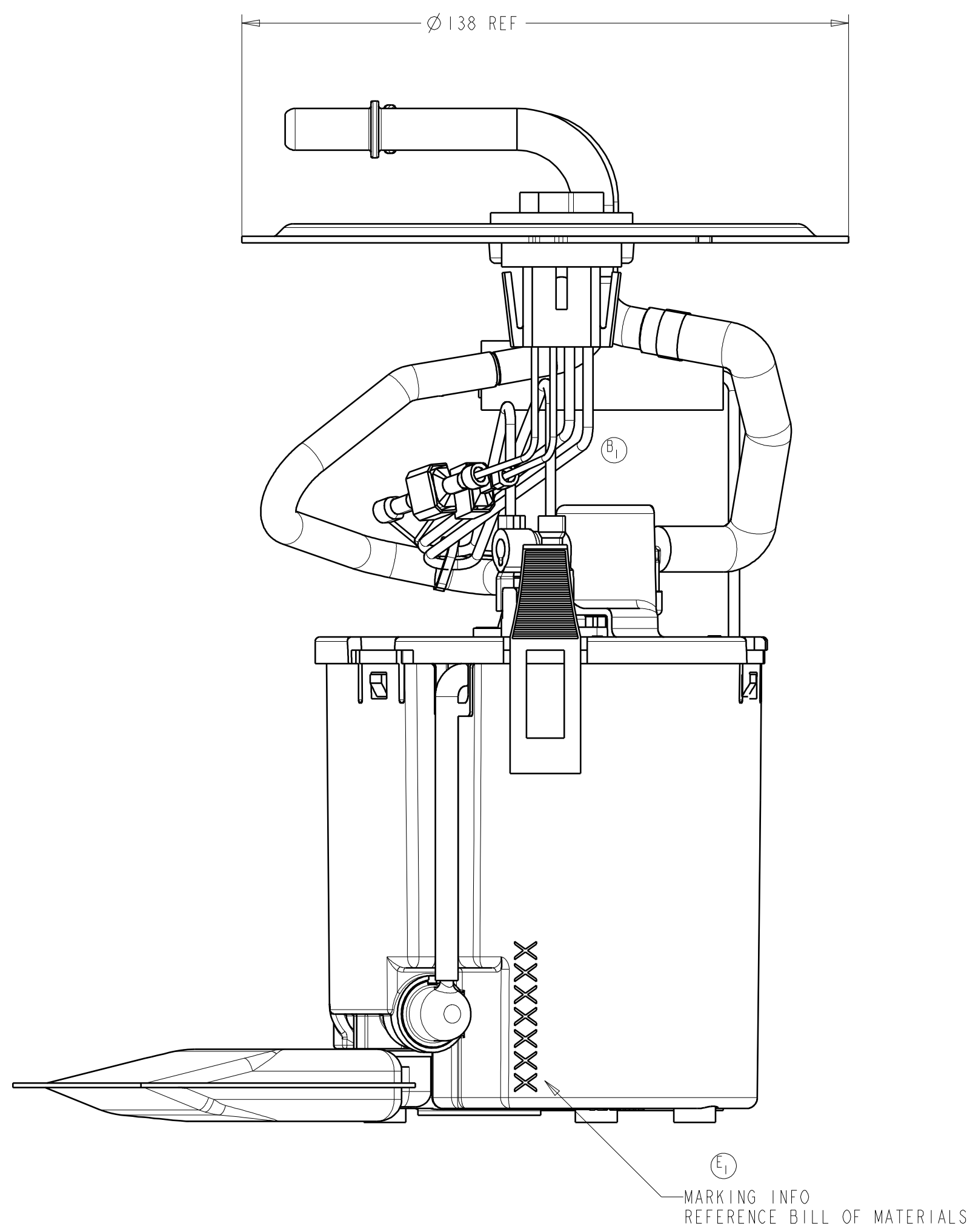
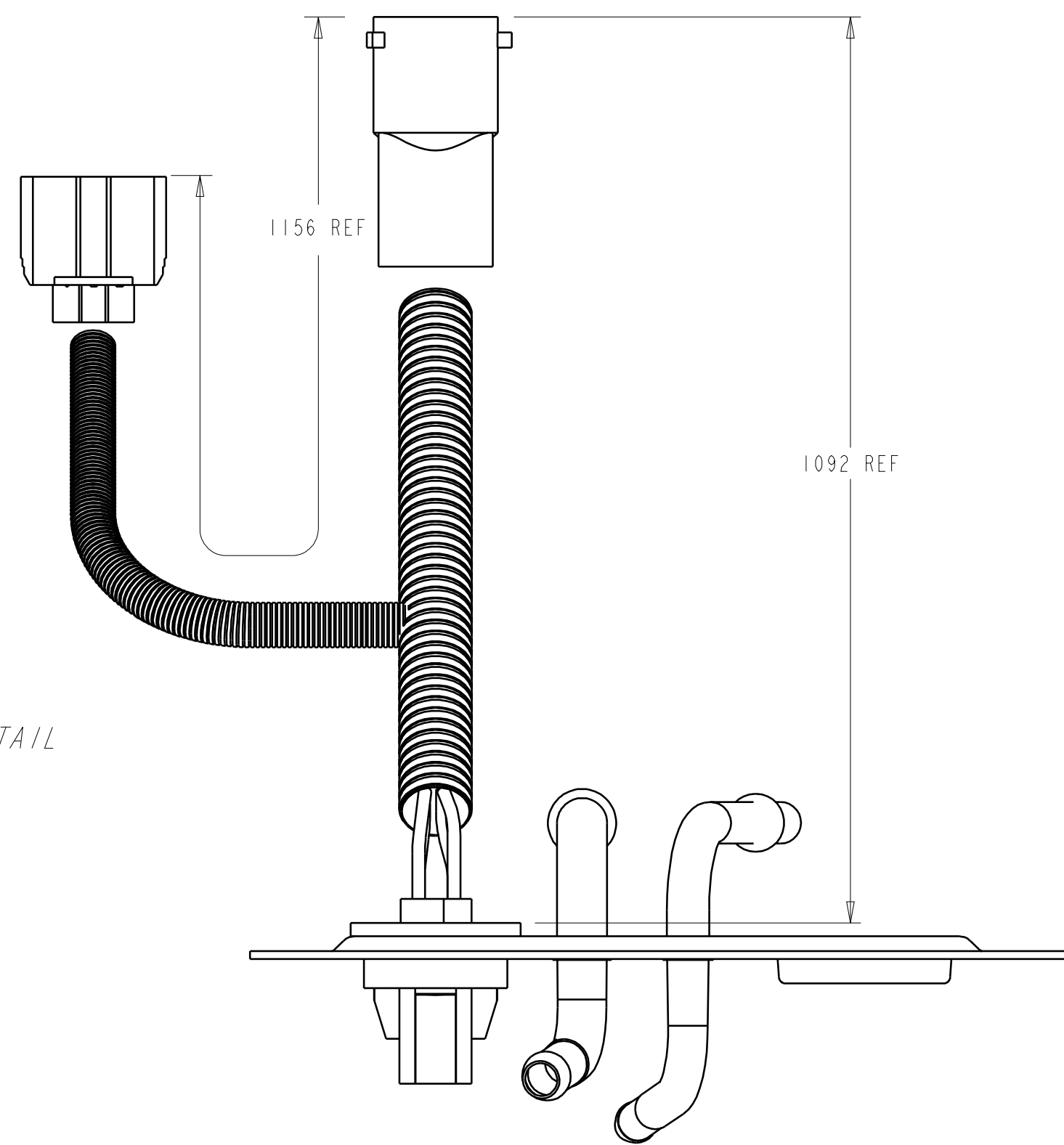

FLOAT POSITION	RESISTANCE (OHMS)
FULL STOP (163.0)	160.5±3.0
EMPTY STOP (0.0)	15±1

- NOTE:
- SPECIAL CUSTOMER PACKAGING REQUIREMENTS MAY CALL FOR THE ADDITION OF SPECIFIC LABELS NOT SHOWN ON THIS DRAWING.
  - SHOWN WIRE ROUTING MAY DIFFER FROM FINISHED PRODUCT.
  - SHOWN RESISTOR CARD AND PUMP TERMINATION MAY DIFFER FROM FINISHED PRODUCT.

INTERNAL USE ONLY DISTRIBUTION CODE		<b>TI Automotive</b>		AFTERMARKET DIVISION 630 COLUMBIA STREET CARO, MICHIGAN 48723	
AF	REF: FM0001785	TOLERANCE UNLESS OTHERWISE SPECIFIED	MATERIAL	SCALE: 1:1	DATE: 4/4/06
DO NOT SCALE PRINT		±0.25	FINISH	DRN: BY: D.P. ZBORAY	
DIMENSIONS AND TOLERANCES PER ANSI/ASME Y14.5M - 1994		±0.13		CHK'D BY:	
PRODUCTION		±0.08		APPR'D BY:	
PRO-E		SIZE	TITLE		DRAWING NO. REV.
			FUEL MODULE OUTLINE		TU212 E